

# INSTRUCTIONS

## Bin Top Kit (KBT70) - (2) 30" Scotsman Ice Machines on BL1360S or BL1660S Bin

Contents:	Quantity:
Bin Top	1
Gasket, 1/2" X 1/4"	16'
Screw, #8 X 1/2"	4
Sealant	1
Support Stiffener Assembly	2

### Install:

1. Remove existing top and front to rear stiffeners by removing (2) Screws from each side of the bin top.
2. Remove existing gaskets from the bin walls.
3. Install new gaskets as shown in "figure 1".
4. Position support stiffener assemblies on bin walls per dimensions shown.
5. Peel off protective coating from the top of the stiffeners.
6. Locate top on bin by first placing the rear of the top against the rear of the bin, then lower the front of the top down onto the stiffeners.
7. Drill (2) 7/64" holes in each end of the bin using holes in the top as a template.
8. Screw (2) #8 x 1/2" screws in each side of the bin top.

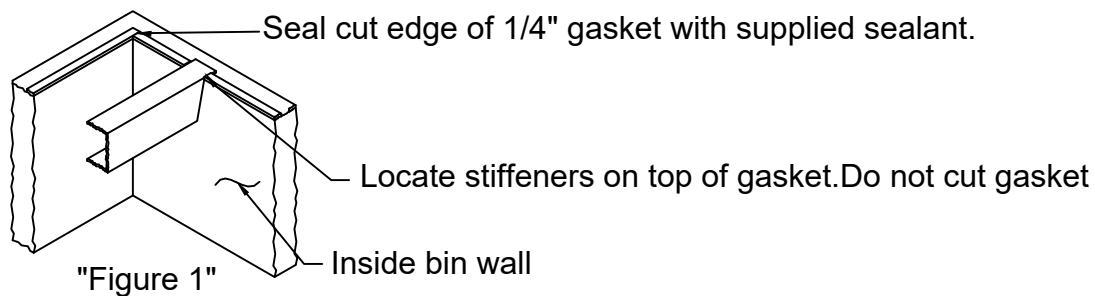

Top view of bin walls and stiffeners

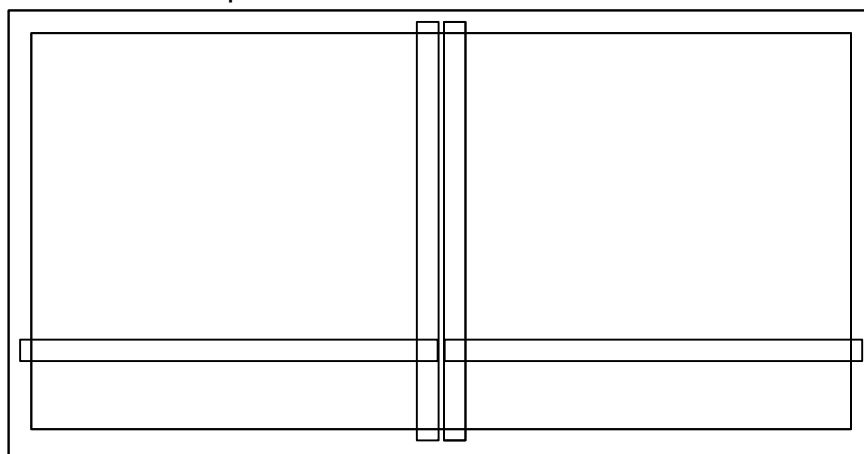

Front

Front view of bin top and stiffeners



Dimensions are taken from the outer bin wall.

# INSTRUCTIONS

## Bin Top Kit (KBT71) - EH222 or MC222L Scotsman Ice Machine on BL1048S Bin

Contents:	Quantity:
Bin Top	1
Gasket, 1/2" X 1/4"	16'
Screw, #8 X 1/2"	4
Assembled Support Frame	1
Support Stiffeners	2
Tube Sealant	1

### Install:

1. Remove existing top and front to rear stiffeners by removing (2) Screws from each side of the bin top.
2. Remove existing gaskets from the bin walls.
3. Install new gaskets as shown in "figure 1".
4. Position support stiffener and frame assembly on bin walls per dimensions shown.
5. Peel off protective coating from the top of the stiffeners.
6. Locate top on bin by first placing the rear of the top against the rear of the bin, then lower the front of the top down onto the stiffeners.
7. Drill (2) 7/64" holes in each end of the bin using holes in the top as a template.
8. Screw (2) #8 x 1/2" screws in each side of the bin top.

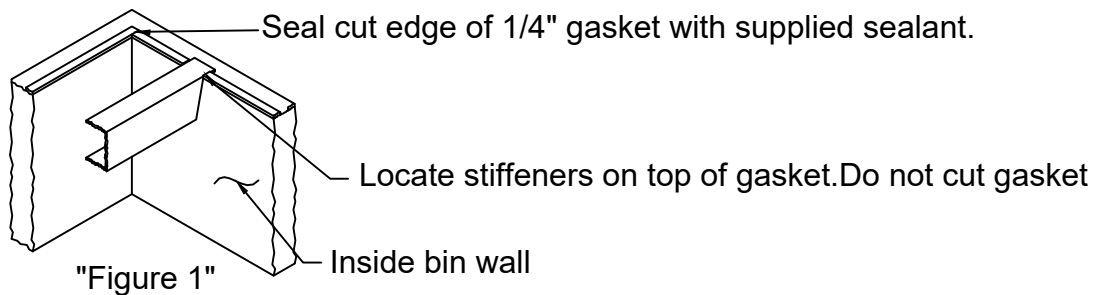

Top view of bin walls and stiffeners

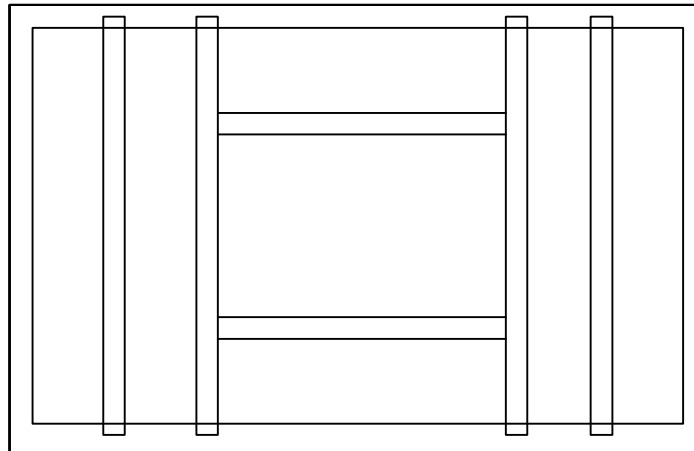

Front

Dimensions are taken from the outer bin wall.

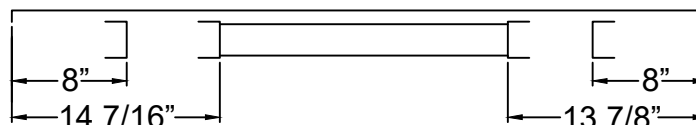

# INSTRUCTIONS

## Bin Top Kit (KBT72) - (2) EH222 or MC222L Scotsman Ice Machines on BL1048S Bin

Contents:	Quantity:
Bin Top	1
Gasket, 1/2" X 1/4"	16'
Screw, #8 X 1/2"	4
Support Stiffener Side-to-Side	2
Tube Sealant	1

### Install:

1. Remove existing top and front to rear stiffeners by removing (2) Screws from each side of the bin top.
2. Remove existing gaskets from the bin walls.
3. Install new gaskets as shown in "figure 1".
4. Position support stiffeners on bin walls per dimensions shown.
5. Peel off protective coating from the top of the stiffeners.
6. Locate top on bin by first placing the rear of the top against the rear of the bin, then lower the front of the top down onto the stiffeners.
7. Drill (2) 7/64" holes in each end of the bin using holes in the top as a template.
8. Screw (2) #8 x 1/2" screws in each side of the bin top.

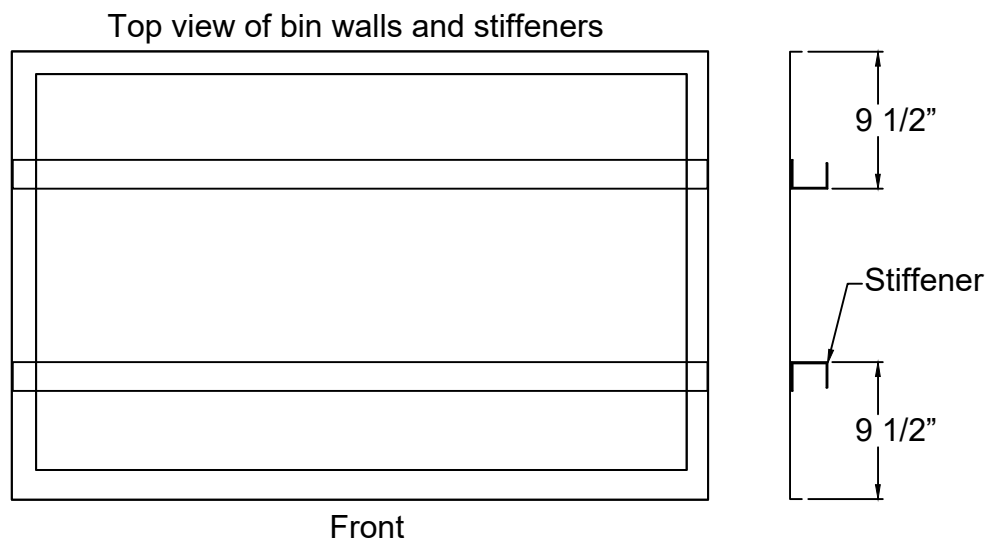
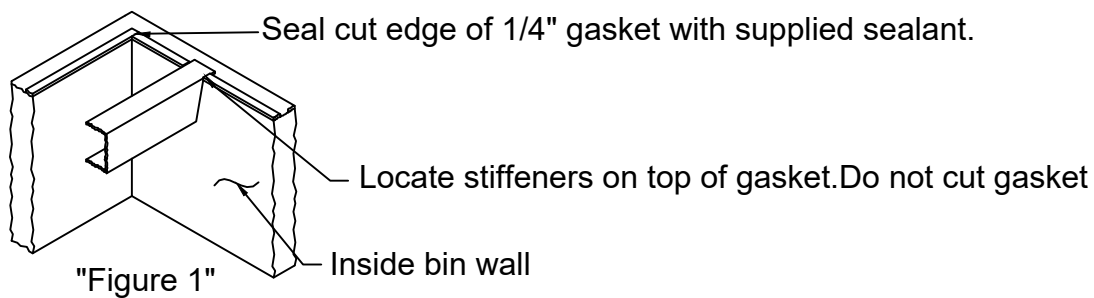

Dimensions are taken from the outer bin wall.

# INSTRUCTIONS

## Bin Top Kit (KBT73) - EH222 or MC222L Scotsman Ice Machine on BL1360S or BL1660S Bin

Contents:	Quantity:
Bin Top	1
Gasket, 1/2" X 1/4"	16'
Screw, #8 X 1/2"	4
Assembled Support Frame	1
Support Stiffeners	2
Tube Sealant	1

### Install:

1. Remove existing top and front to rear stiffeners by removing (2) Screws from each side of the bin top.
2. Remove existing gaskets from the bin walls.
3. Install new gaskets as shown in "figure 1".
4. Position support stiffener and frame assembly on bin walls per dimensions shown.
5. Peel off protective coating from the top of the stiffeners.
6. Locate top on bin by first placing the rear of the top against the rear of the bin, then lower the front of the top down onto the stiffeners.
7. Drill (2) 7/64" holes in each end of the bin using holes in the top as a template.
8. Screw (2) #8 x 1/2" screws in each side of the bin top.

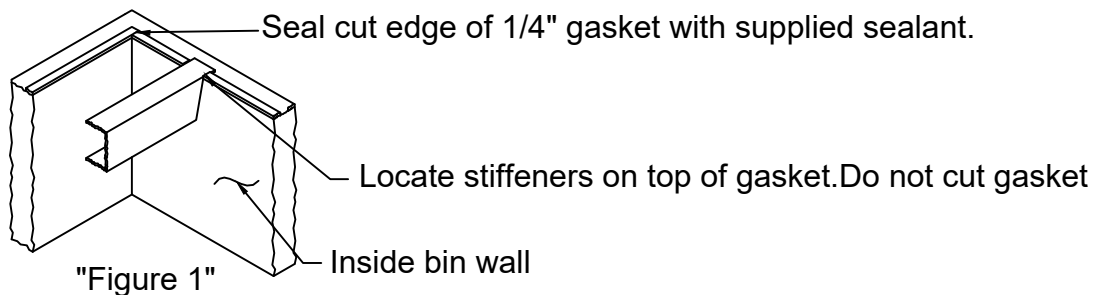

"Figure 1"

Top view of bin walls and stiffeners

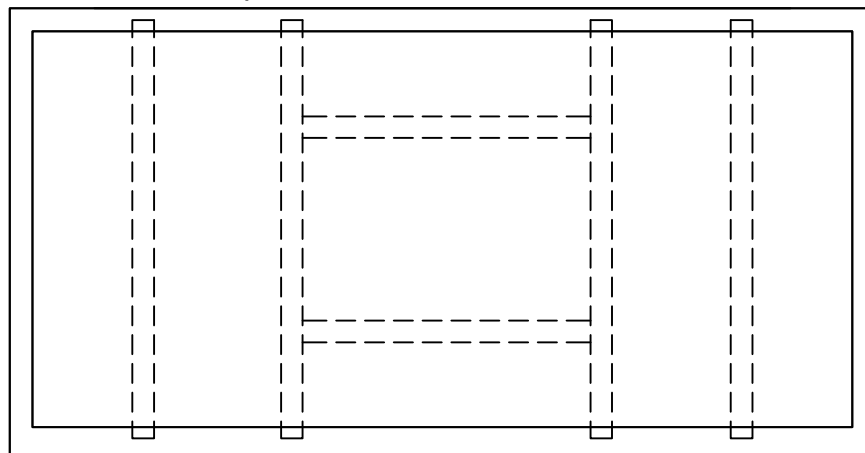

Front

Dimensions are taken from the outer bin wall.

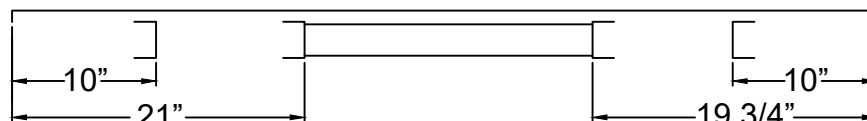

# INSTRUCTIONS

**Bin Top Kit (KBT74) - (2) EH222 or MC222L Scotsman Ice Machine on BL1360S or BL1660S bin**

Contents:	Quantity:
Bin Top	1
Gasket, 1/2" X 1/4"	16'
Screw, #8 X 1/2"	4
Assembled Support Frame	2
Tube Sealant	1

## Install:

1. Remove existing top and front to rear stiffeners by removing (2) Screws from each side of the bin top.
2. Remove existing gaskets from the bin walls.
3. Install new gaskets as shown in "figure 1".
4. Position support stiffener and frame assembly on bin walls per dimensions shown.
5. Peel off protective coating from the top of the stiffeners.
6. Locate top on bin by first placing the rear of the top against the rear of the bin, then lower the front of the top down onto the stiffeners.
7. Drill (2) 7/64" holes in each end of the bin using holes in the top as a template.
8. Screw (2) #8 x 1/2" screws in each side of the bin top.

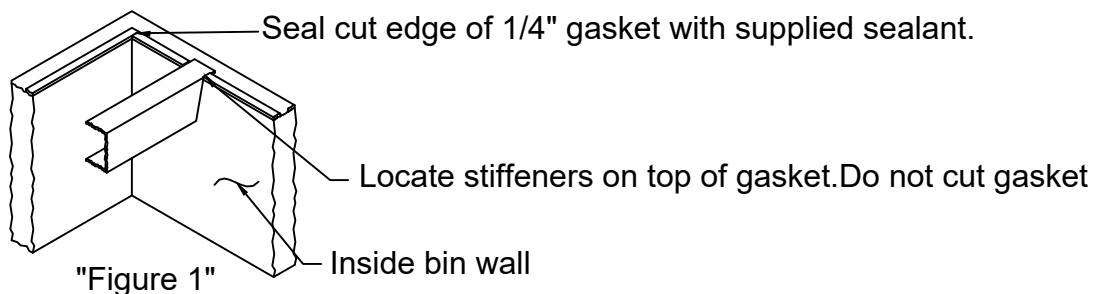

Top view of bin walls and stiffeners

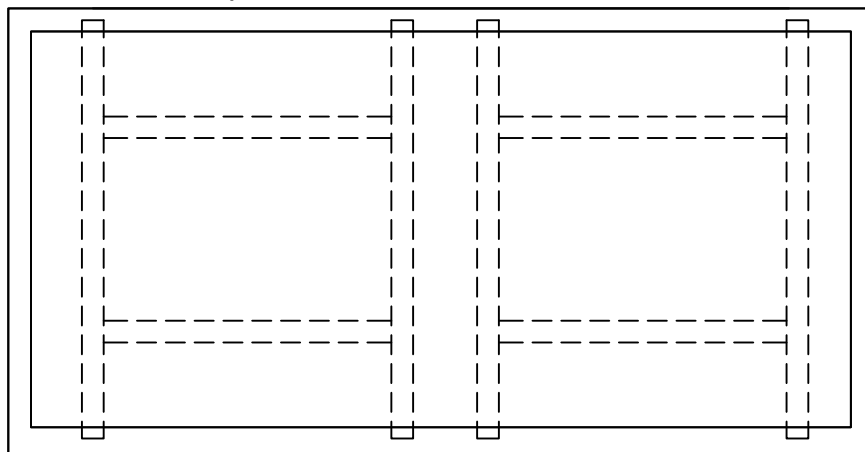

Front

Dimensions are taken from the outer bin wall.

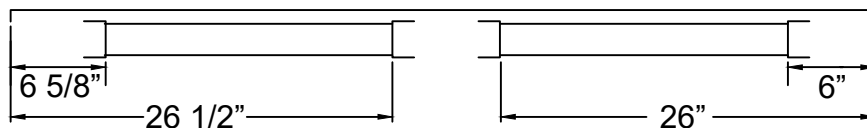

# INSTRUCTIONS

## Bin Top Kit (KBT75) - (2) 30" Scotsman Ice Machines on ICS1360 Bin

Contents:	Quantity:
Bin Top	1
Gasket, 1/2" X 1/4"	16'
Screw, #8 X 1/2"	4
Sealant	1
Support Stiffener Assembly	2

### Install:

1. Remove existing top and front to rear stiffeners by removing (2) Screws from each side of the bin top.
2. Remove existing gaskets from the bin walls.
3. Install new gaskets as shown in "figure 1".
4. Position support stiffener assemblies on bin walls per dimensions shown.
5. Peel off protective coating from the top of the stiffeners.
6. Locate top on bin by first placing the rear of the top against the rear of the bin, then lower the front of the top down onto the stiffeners.
7. Drill (2) 7/64" holes in each end of the bin using holes in the top as a template.
8. Screw (2) #8 x 1/2" screws in each side of the bin top.

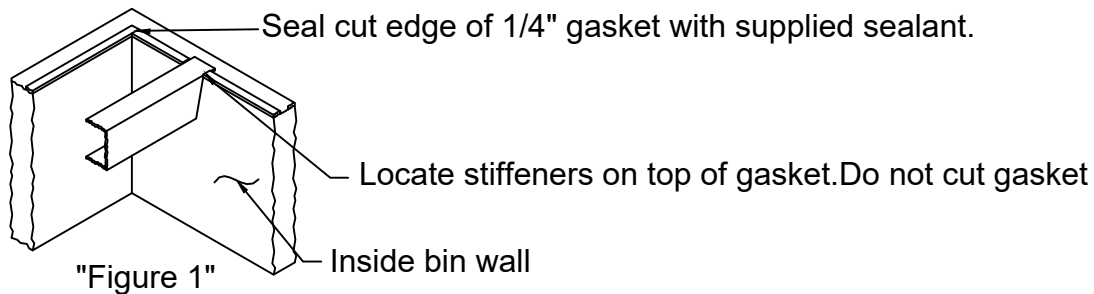

Top view of bin walls and stiffeners

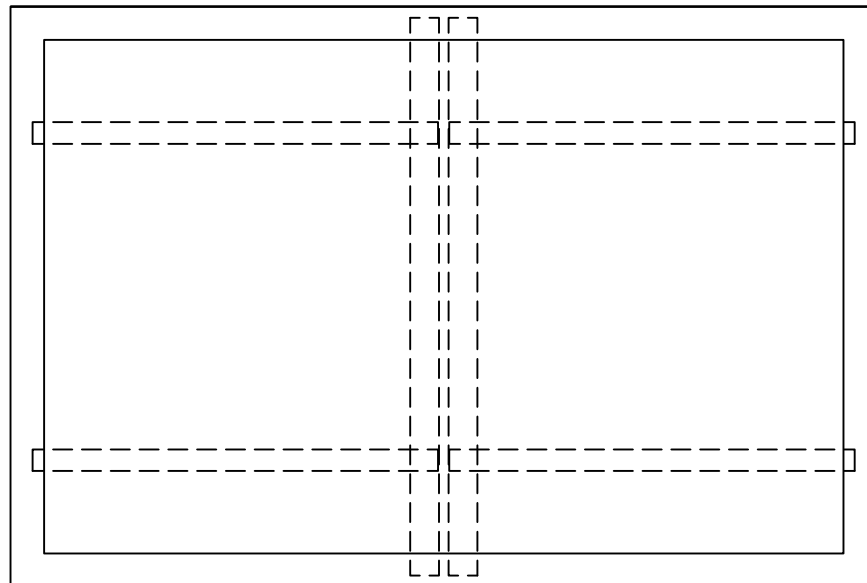

Front

Front view of bin top and stiffeners

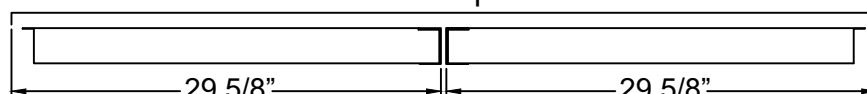

Dimensions are taken from the outer bin wall.